

PUMP PERFORMANCE:

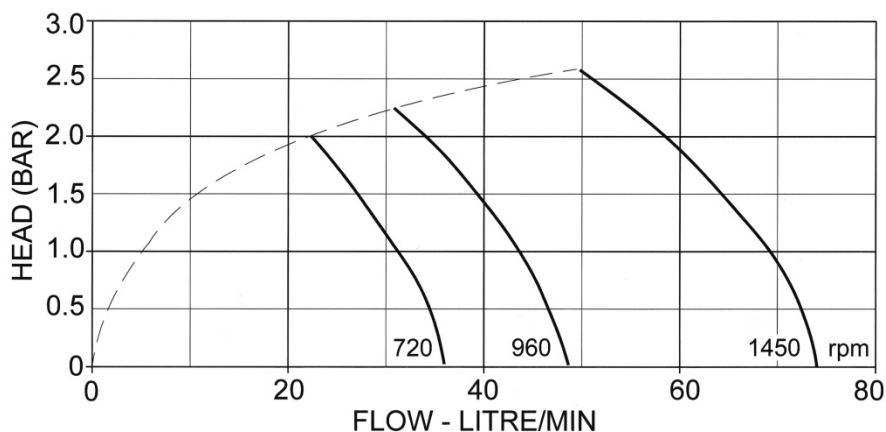

DIMENSIONS:

WEIGHT: 2.1 kg

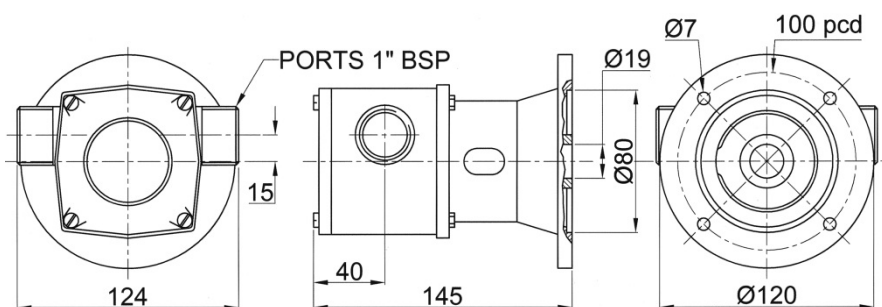

SPECIFICATIONS:

IMPELLER	Neoprene standard
SEAL	Carbon / Ceramic mechanical face seal Optional: Tungsten Carbide / Ceramic hard faced
SEAL ELASTOMERS	Nitrile
PUMP HEAD	Epoxy
END COVER	Epoxy
SHAFT	Epoxy coated stainless steel shaft extension
BEARINGS	Uses motor bearings
MOTOR ADAPTOR	Epoxy coated cast iron
PORTS	1" BSP external thread to BS21 (DIN2999)

MODEL RANGE:

TEMPERATURE RANGE	4°C to 80°C
MECHANICAL SEAL OPTIONS	
Carbon / Ceramic	28360-2101
Tungsten Carbide / Ceramic hard faced	

TYPICAL APPLICATIONS:

Acids and alkalis, compounds, copper sulphate, methyls, alcohols • Industrial chemicals, resins, oils, fatty acids, brine • Detergents, soaps • Paints, dyes, inks • Transfer, filling, recirculation and agitation, spillage return, spraying, coating, filtration • Viscous, shear-sensitive fluids, small solids in suspension



a xylem brand

28360 SERIES EPOXY FLEXIBLE IMPELLER HEAD KIT



- * Self primes from dry up to 3 metres
- * Flows up to 75 litres per minute
- * Pressure up to 1.7 bar.
- * Handles solids - max. 5mm dia
- * Non pulsating flow, proportional to speed
- * Handles viscosities up to 1,000 centiPoise
- * Minimal shear to thixotropic fluids
- * Fits IEC standard motor B3/B14, frame 80

Xylem Water Solutions UK Ltd
Bingley Road
Hoddesdon
Hertfordshire • EN11 0BU • UK

Telephone: +44 (0)1462 480380
Fax: +44 (0)1462 482422
mail@cleghorn.co.uk
www.jabscoshop.com

xylem
Let's Solve Water